

## Type 1150H Reid Vapor Test Gauge



### FEATURES

- Accuracy ASME B40.100 Grade 2A ( $\pm 0.5\%$  of span)
- Dial size 4½" only
- White dial and black pointer

The Ashcroft® Type 1150H is a specialized pressure gauge used by the petroleum industry to measure vapor pressures of various petroleum products.

### PRODUCT SPECIFICATIONS

<b>Model Number:</b>	1150H
<b>Accuracy:</b>	.5% ASME Grade 2A
<b>Case Style:</b>	Solid Front
<b>Case Material:</b>	Cast Aluminum
<b>Dial Size:</b>	4½" (45)
<b>Dial Material &amp; Color:</b>	Black Aluminum with White Markings
<b>Ring Type:</b>	Aluminum, Threaded
<b>Bourdon Tube Material:</b>	Grade A Phosphor Bronze (A)
<b>Socket Material:</b>	Brass
<b>Connection Size:</b>	¼ NPT
<b>Connection Location:</b>	Lower (L)
<b>Range Limits:</b>	15-1000 psi
<b>Mounting:</b>	Stem
<b>Movement:</b>	400 SS
<b>Pointer:</b>	Micrometer Adjustable
<b>Window:</b>	Glass
<b>Warranty:</b>	1 Year

### DIMENSIONS

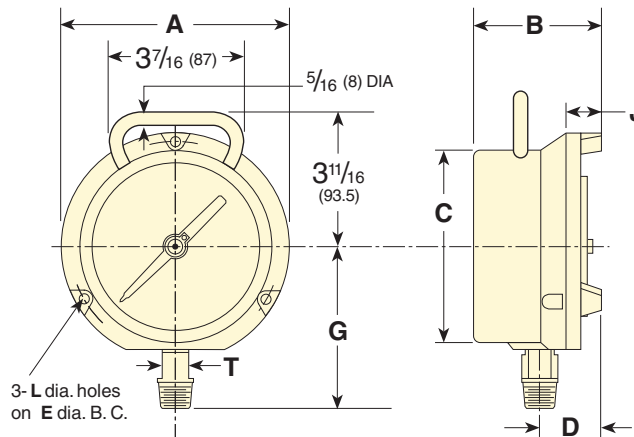

Dial Size Inches	A	B	C	D	E	G	J	L	T	Wgt (lbs)
4½	5¼ (148)	3⅞ (86)	4⅞ (124)	1⅞ (41)	5⅞ (137)	3⅞ (100)	1⅞ (27)	.218 (6)	⅞ (16)	2.5

### HOW TO ORDER:

	45	1150H	02L	XXX	600#
1. Dial size—4½"	_____	_____	_____	_____	_____
2. Case type—1150H	_____	_____	_____	_____	_____
3. Connection size—¼ (02)	_____	_____	_____	_____	_____
4. Connection location—Lower (L)	_____	_____	_____	_____	_____
5. Optional features	_____	_____	_____	_____	_____
6. Standard pressure range—600 psi	_____	_____	_____	_____	_____

## Type 1150H Reid Vapor Test Gauge

CASE TYPE								
Gauge Type Number	Dial Size (inches)	Case & Ring Material Finish	Bourdon Tube & Tip Material	Socket Material	Pressure Range (psi)	Pointer	Movement	NPT Connection
Reid Vapor Test 1150H	4½	Case: Aluminum Ring: Threaded Aluminum black epoxy coated	Phosphor Bronze Tip: Brass  (All joints silver brazed)	Brass	15/600	Micrometer Adjustable	Stainless steel Teflon coated, pinion and sector shaft, rotary geared	¼

STANDARD METRIC RANGES						
Range		Dial Graduations		Range	Dial Graduations	
kg/cm <sup>2</sup> (Kilograms per sq. cm.)	Bar	Figure Interval	Minor Graduation	kPa (kilopascal)	Figure Interval	Minor Graduation
<b>Pressure</b>						
0/1	0/1	0.1	0.01	0/100	10	1
0/1.6	0/1.6	0.2	0.02	0/160	20	2
0/2.5	0/2.5	0.5	0.05	0/250	50	5
0/4	0/4	0.5	0.05	0/400	50	5
0/6	0/6	0.5	0.1	0/600	50	10
0/10	0/10	1	0.1	0/1000	100	10
0/16	0/16	2	0.2	0/1600	200	20
0/25	0/25	5	0.5	0/2500	500	50
0/40	0/40	5	0.5	0/4000	500	50

STANDARD RANGES		
Pressure Range (psi)	Figure Interval	Minor Graduation
0/15	1	0.1
0/30	2	0.2
0/60	3	0.2
0/100	4	0.25
0/160	5	0.5
0/200	10	1.0
0/300	10	1.0
0/400	10	1.0
0/600	20	2.0